

SELENE 103/108 OCEAN EXPLORER

NEW MODELS



THE SELENE SUPER YACHTS...

The *Selene 103/108 Ocean Explorer Line* is the result of an international collaboration of designers and architects under Howard Chen's design team leadership. Working with renowned Dutch architect Guido De Groot we have developed a contemporary long range yacht whilst capitalizing on our quality construction and reputation for experience and innovation in the displacement yacht sector. A first look at the *Selene 103/108* show a number of the Selene family traits with a powerful raised pilothouse, Portuguese bridge, and bulbous bow. But a contemporary twist is also apparent in the addition of the large side windows in the hull and stainless anchor pockets. They are sure to appeal to existing owners and big boat enthusiasts alike and takes the simple and proven concept of the fuel efficient and seaworthy long range yacht to a new level of luxury that is intended to compete directly with the finest European yards, but with all of the advantages of GRP. Equipped with twin 475HP engines from MTU's 60 series, the *Selene 103/108* carry more than 23 000 litres of fuel giving enough range to get to reach the Marquesas from the West coast of the United States. What is catching eyes is an unusual combination of modern styling and vibes and the capabilities of an ocean cruiser. Where most explorers are tall, square and blunt, the *Selene 103/108 Ocean Explorer* are graceful and curvaceous. The *Selene 103/108* have four staterooms; three guest cabins and a full-beam owner's cabin, a laundry room and a crew area with two cabins and a mess area. In November 2017, her smaller sister, the *Selene 92 Explorer* was listed by *Southern Boating* as one of the « Top Ten Long Range Cruisers ».

LOA: 91'-11" (27.93m)	FUEL: 6200 USG (23 000L)
BEAM: 23'-9" (7.23m)	WATER: 800 USG
DRAFT: 7'-6" (2.29m)	INTERIOR: 4 cabins, 2 crew cabins
DISPLACEMENT: 374,200Lbs (158t)	SPEED: 11 kts



For more information: howardchen@selenetrawlers.com
www.seleneoceanyachts.com



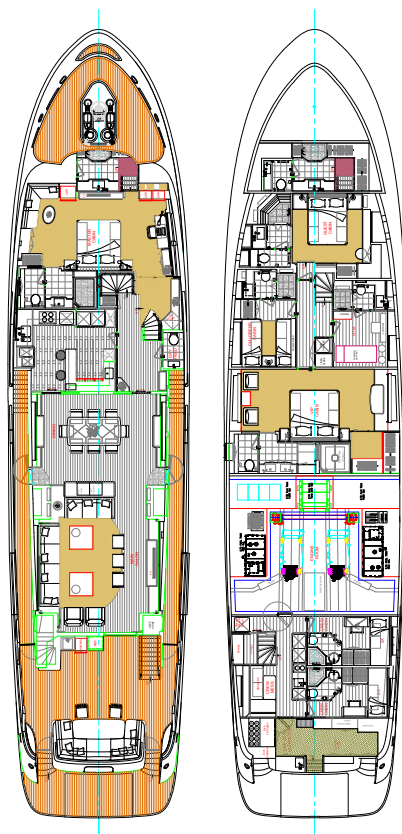

Explorer Yachts

« The features and qualities that set an explorer yacht apart from a long-range or blue-water yacht are many. . . Is it designed and built to handle extreme weather conditions with a sea-kindly hull form? Is the safety and comfort of the passengers and crew a priority? Does it have a sufficient fuel volume to travel 3,000 nautical miles at 10 knots? With the Selene 103 Explorer, the answer is yes to all these questions! »

Howard Chen, 2017

